

Model 219D

Differential Pressure Transmitters

Model 219D is a transmitter version of 218D differential pressure transducer. These transmitters are made of 316L stainless steel (SS) with a laser welded construction. 219D transmitters are low profile products with threads as the process interface for easy installation. The threads can be made in female or male types.

Model 219D is designed for measuring the differential pressure of gases or dilute liquids. The measuring ranges span from 0~0.1 bar up to 0~35 bar. Its output is either 4~20 mA or 0~5 Vdc with accuracy up to 0.5%fs (fs = full scale). The non-zero output at ZERO load provides an easy solution for diagnosis.



Features:

- diff. pressure ranges: 0~0.1bar, ..., ~35bar
- static pressure: 1000%fs (with a limit of 100bar max.)
- output signal: 4~20mA (standard), 0~5Vdc
- measuring accuracy: 0.5%fs
- compensated temperature range: 0~80 °C
- materials: 316L (pressure diaphragm), 316 (wetted parts)
- construction: laser welded construction, rigid and robust
- housing protection: IP65 (with connector), IP66 (with cable)

Dimensions:

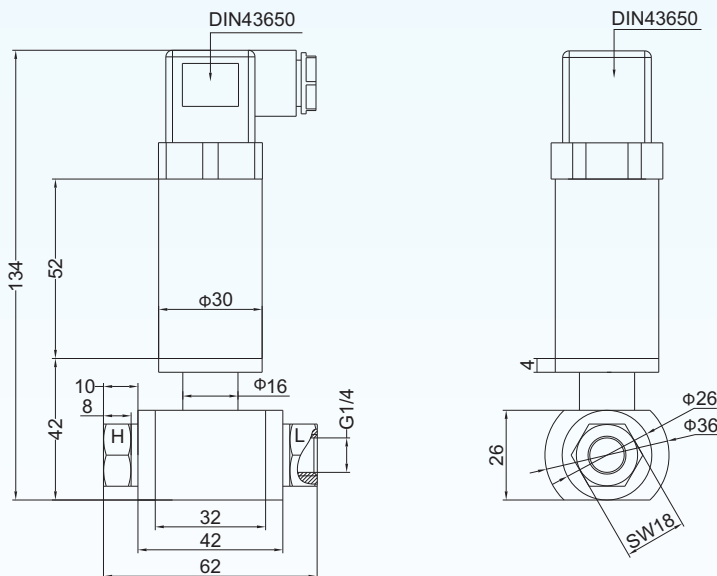

Electrical connection:

(4~20mA current loop configured with DIN43650)

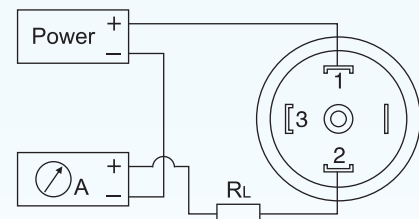

BCM SENSOR TECHNOLOGIES BVBA

Model 219D Differential Pressure Transmitters



Technical data:

Parameter	Units	Specifications
pressure medium		gases or dilute-liquids, compatible to the 316L stainless steel
differential pressure ranges	barD	0~0.1, ~0.2, ~0.35, ~0.7, ~1, ~2, ~3.5, ~7, ~10, ~20, ~35
differential overload pressure*	%fs	1000 (with a limit of 100 bar max.)
static pressure	%fs	1000 (with a limit of 100 bar max.)
output signal		4~20mA (standard), 0~5Vdc
accuracy	%fs	≤ ±0.5
static pressure effect on diff. pressure	%fs/bar	0.05
long term stability	%fs/year	< 0.2 (ranges ≥ 0~2 bar); < 0.5 (other ranges)
supply voltage	Vdc	15, ..., 30
load resistance	Ω	350~1100 (for current output)
	Ω	> 5000 (for voltage output signal)
insulation resistance	MΩ @500Vdc	500
storage temperature	°C	-40 ~ +135
operating temperature	°C	-40 ~ +125
compensated temperature	°C	0~80 (other range available on request)
temperature coefficient on zero	%fso/°C	≤ ±0.03
temperature coefficient on span	%fso/°C	≤ ±0.03
process interface	thread	G1/4 female (standard), G1/4 male, other threads available on request
	connector	DIN 43650 (other type plug-in connectors available on request)
electrical interface	cable	PVC shielded cable (1.5 meter length)
environment protection		IP65 (with connector), IP66 (with cable)
diaphragm material		316L SS
wetted parts material		316 SS
housing material		304 SS
net weight	g	~360

The specifications and dimensions listed above are subject to change without prior notice.

General conditions for measurements: supply voltage = 24Vdc, temperature = 25°C, humidity = 60%RH.

*: differential overload pressure = maximum limit of differential pressure

How to order:

model-range-static pressure-output-accuracy-supply voltage-pressure interface-electrical interface-customer requests

ordering code example: 219D-0/0.35barD-1000%fs-4/20mA-0.5%fs-15/30Vdc-G1/4(female)-DIN43650

219D-0/10barD-100bar-4/20mA-0.5%fs-15/30Vdc-G1/4(female)-DIN43650



BCM SENSOR TECHNOLOGIES BVBA